

# Instruction for CUK005 Lithium balance charger

## 1.0 Technical Features:

1. The CUK005, whose whole charging process is controlled by micro computer, is more accurate, safe and reliable.
2. CUK005 is suitable for 7.4V/ 11.1V Li-ion or Li-Polymer battery pack, which automatically inspects charging status which is shown by LED.
3. Automatic function of detected compensating voltage effectively utilizes the maximal capacity of 2-3 Li-Polymer battery pack.
4. Automatic balance controlling the single battery voltage between the range of  $4.2 \pm 05V$  by automatic detecting each battery voltage in the battery pack.
5. Input jack: DC 15-18V 1000 mA

## 2.0 Matters Needing Attention:

1. This charger is suitable for 2-3 cell Li-ion or Li-polymer battery pack. Don't disassemble, refit or use for other purposes. (such as 7.4V 480-1200 mAh, 11.1V 800-2200mAh).
2. Never charge it as soon as the battery pack is just finished flight, whose surface temperature doesn't cool down. Otherwise, the battery pack will be damaged or accident will be taken place.
3. It is forbidden to be charged when the shape of battery pack is distorted or the battery pack is swollen, because damaged battery pack may result in short circuit, burn, or explosion.
4. This charger is only fit for charging indoors, never exposed in rain or snow.
5. The charger should be put in the ventilated place, never close to heat source or electric equipment.
6. Liquid or sundries are forbidden to enter the charger. Otherwise, immediately turn off the power supply and disconnect the battery pack, and then send to your local dealer or our company for maintenance.
7. Put the CUK005 at a flat place and avoid dropping or bumping.
8. Before connecting battery to CUK005, please assure that the polarities of battery and CUK005 are correct in order not to damage your battery and charger.
9. denotes that electronic equipment and electric products should be collected separately; denotes that it is only used indoors.

## 3.0 Identification for CUK005

1. Plug in a 15-18V 1000mA DC power at the input jack (notice the polarity). The status LED is lighting in red.
2. When charging a 7.4V Li-ion or Li-polymer battery pack, plug the pin of your battery into the 2 CELL jack of your CUK005 in a certain direction. Then the charging LED will become red and flashing, and this means the battery has entered charging status. When your battery is fully charged, the LED will become green.
3. When charging a 11.1V Li-ion or Li-polymer battery pack, plug the pin of your battery into the 3 CELL jack of your Z in a certain direction. Then the charging LED will become red and flashing, and this means the battery has entered charging status. When your battery is fully charged, the LED will become green.

**Notice:** ① every time only one group of battery pack can be charged. It is forbidden to charge two groups; otherwise your charger or battery will be damaged or burnt.

② warning: against recharging the non-rechargeable batteries.

## 4.0 Connection Diagram

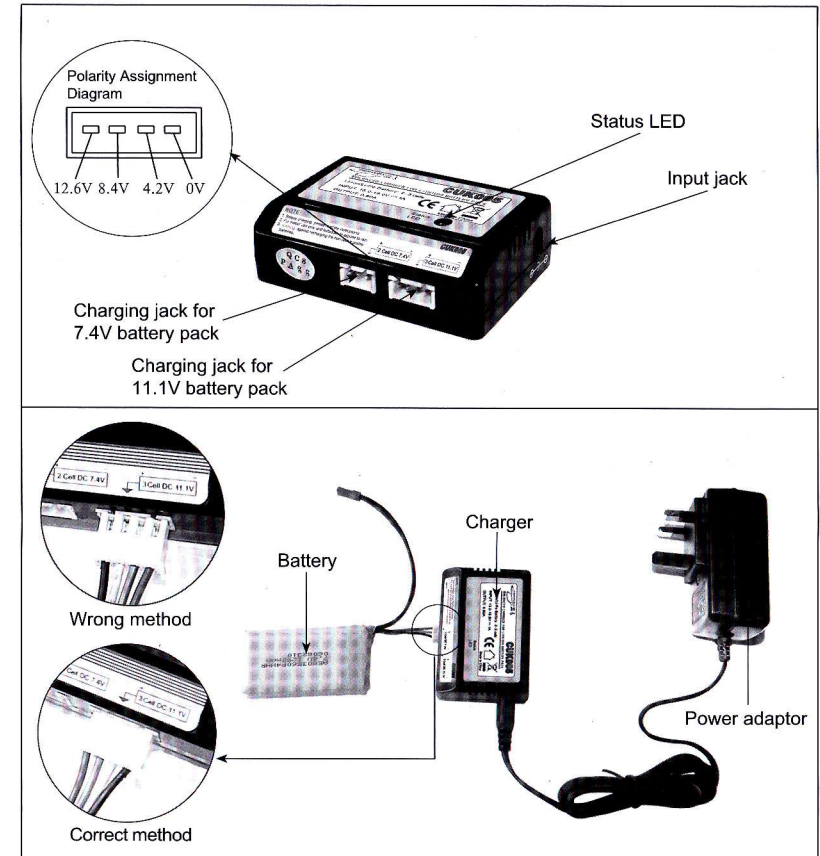

## 5.0 Technical Specification

Output Current: 800mA

Input Voltage: DC 15-18V 1000mA

Output Voltage:

2cell DC 7.4V Jack	3cell DC 11.1V Jack
8.4V	12.6V